

Acacia Park buyer layout

Colour-coded overview with plot numbers and main street access.

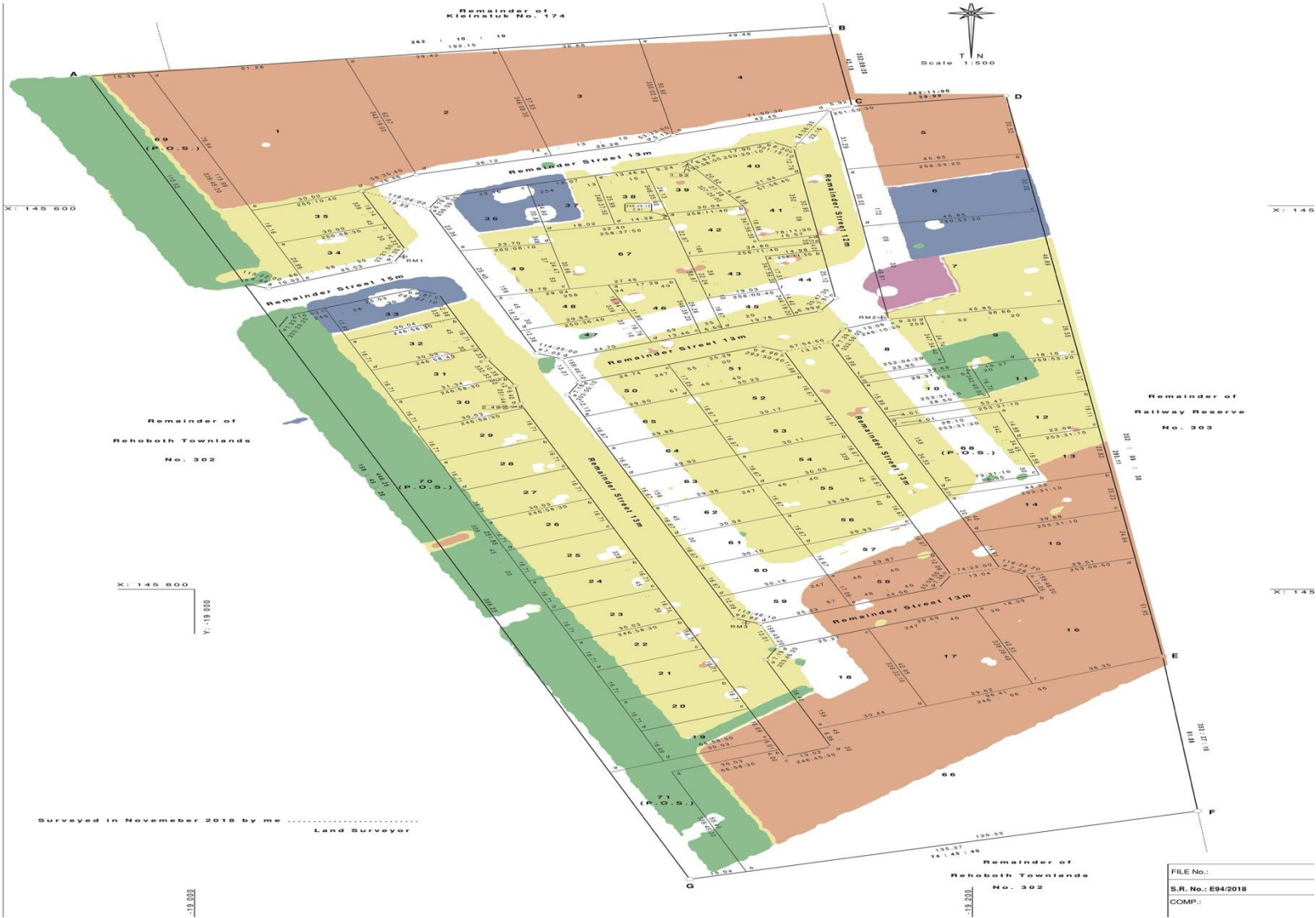

How to read the plan

- Use the plot number first.
- Check the colour for land use.
- Review the nearest street access.
- Compare nearby open space and edges.

Colour key

- Residential
- General residential
- Institutional
- Business
- Public open space
- Private open space
- Street

FILE No.:
S.R. No: E94/2018
COMP.:

Choose your plot by number

Enlarged plot-number callouts for quick buyer reference.

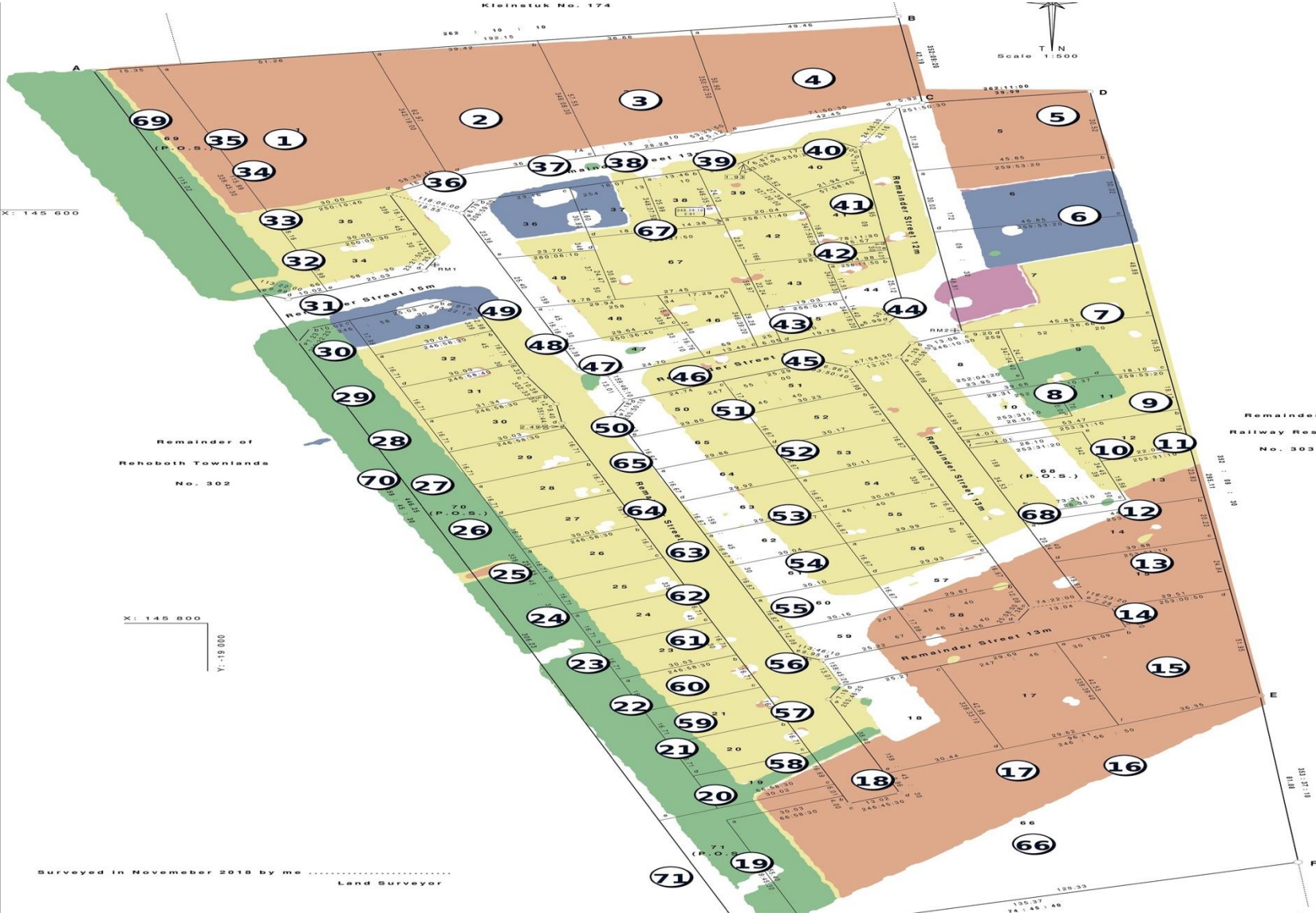

Buyer use

1. Shortlist

Mark the plots you want to price or inspect.

2. Compare

Check position, access and surrounding land use.

3. Confirm

Ask for availability, price and service status.

Tip: quote the plot number in every enquiry so the seller or agent can respond clearly.

Simple land-use guide

Use the colour before comparing price, size and location.

Residential



Standard housing plots for individual home use.

General residential



Larger residential-use plots shown in orange.

Business



Blue plots indicate business use areas.

Institutional



Purple indicates institutional use.

Open space



Green areas indicate public open space.

Private open space



Light green/yellow indicates private open space.

The colour guide helps buyers separate residential plots from business, institutional and open-space areas at a glance.

Use this together with the numbered plan on slide 2.



Buyer enquiry checklist

Use this before requesting a viewing, quotation or offer pack.

Plot number

State the exact plot number from slide 2.

Land use

Confirm that the colour matches the intended use.

Access

Check the street position and entry route.

Availability

Ask whether the plot is still available.

Pricing

Request price, deposit terms and transfer costs.

Services

Ask for service status and connection details.

Suggested enquiry wording

Please confirm the latest availability, price, service status and viewing process for Plot [number] in Acacia Park.